

Piezo Alarm

EPA-45U SERIES PIEZO ALARM



DIMENSIONS



Color Black
ABS Housing Material

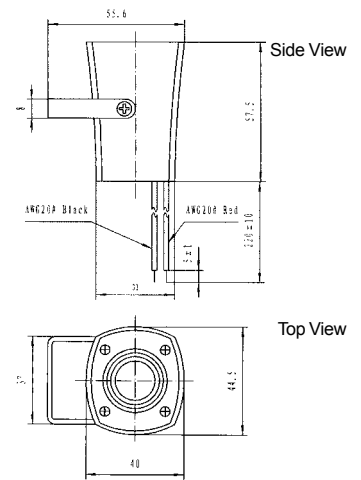

all dimensions are in mm

Model No	EPA-45U1-12V	EPA-45U6-12V
Rated Voltage	12 VDC	12 VDC
Operating Voltage	6~16 VDC	6~16 VDC
Max. Rated Current	210mA/12 VDC	200mA/12VDC
Min. Sound Pressure Level	105dB at 12VDC/100cm	100dB at 12VDC/100cm
Resonant Frequency	1.5~3.5KHz	1.5~3.5KHz
Tone Nature	Warble	6 Tone
Operating Temperature	-20~+60 ; ±	-20~+60 ; ±
Store Temperature	-30~+70 ; ±	-30~+70 ; ±
Weight	65g	65g
N.W / G.W	28 / 29 Kgs	28 / 29 Kgs
Meas / QTY	46 x 29 x 35cm / 250 pcs	46 x 29 x 35cm / 250 pcs

* Value applying at rated voltage

EPA-60S SERIES PIEZO ALARM

DIMENSIONS



Color White
ABS Housing Material
Piezo Screamer Water proof

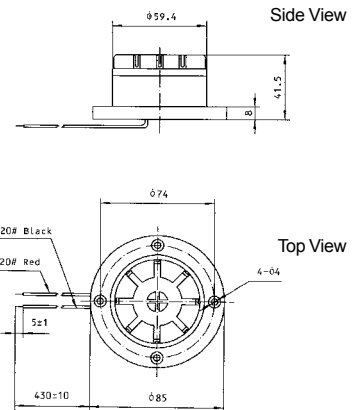

all dimensions are in mm

Model No	EPA-60S1-12V
Rated Voltage	12 VDC
Operating Voltage	6~15 VDC
Max. Rated Current	280mA/12 VDC
Min. Sound Pressure Level	105dB at 12VDC/100cm
Resonant Frequency	2.8 ; ±0.5KHz
Tone Nature	Warble
Operating Temperature	-20 ~ +60 ; ±
Store Temperature	-30 ~ +70 ; ±
Weight	70g
N.W / G.W	9 / 10 Kgs
Meas / QTY	46 x 29.5 x 35cm / 100 pcs

* Value applying at rated voltage

EPA-55S SERIES PIEZO ALARM

DIMENSIONS



Color Black
ABS Housing Material
Steel Tab Mounted

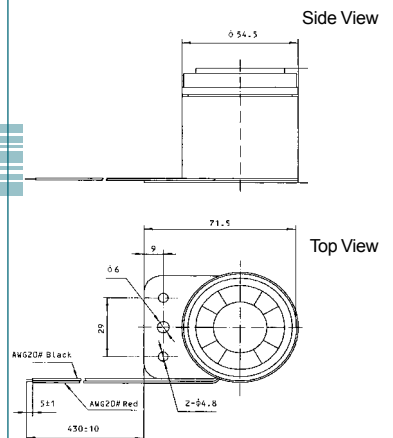

all dimensions are in mm

Model No	EPA-55S1-12V
Rated Voltage	12 VDC
Operating Voltage	6~15 VDC
Max. Rated Current	300mA
Min. Sound Pressure Level	105dB/100cm
Resonant Frequency	1.5 ~ 4KHz
Tone Nature	Warble
Operating Temperature	-20 ~ +60 ; ±
Store Temperature	-30 ~ +70 ; ±
Weight	110g
N.W / G.W	10 / 11 Kgs
Meas / QTY	46 x 29.5 x 35cm / 150 pcs

* Value applying at rated voltage

The information contained herein is believed to be correct, but no guarantee for accuracy, completeness, DSW Electronics Ltd. reserves the right to make changes without notification.

EPA-62U SERIES PIEZO ALARM

Model No EPA-62U1-12V

Rated Voltage	12 VDC
Operating Voltage	6~15 VDC
Max. Rated Current	250mA/12VDC
Min. Sound Pressure Level	105 _i ±2dB at 12VDC/100cm
Resonant Frequency	1.5~3.5KHz
Tone Nature	Warble or Hi-low
Operating Temperature	-20~+60 _i ±æ
Store Temperature	-30~+70 _i ±æ
Weight	129g
N.W / G.W	13 / 14 Kgs
Meas / QTY	46 x 29.5 x 35cm / 100 pcs



Color Black
ABS Housing Material

DIMENSIONS

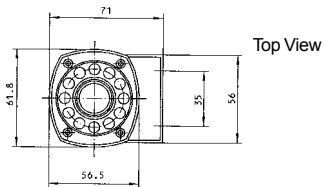
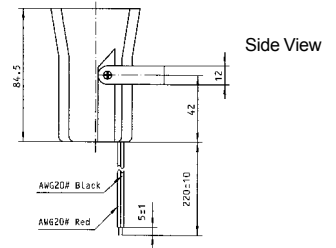

all dimensions are in mm

* Value applying at rated voltage

EPA-52S SERIES PIEZO ALARM

Model No EPA-52S1-12V EPA-52S1-24V

Rated Voltage	12 VDC	24VDC
Operating Voltage	8~15 VDC	12~24VDC
Max. Rated Current	280mA/12VDC	200mA/24 VDC
Min. Sound Pressure Level	105dB at 12VDC/100cm	105dB at 24VDC/100cm
Resonant Frequency	1.5~3.5KHz	1.5~3.5KHz
Tone Nature	Warble	Warble
Operating Temperature	-20 ~ +60 _i ±æ	-20 ~ +60 _i ±æ
Store Temperature	-30 ~ +70 _i ±æ	-30 ~ +70 _i ±æ
Weight	80g	55g
N.W / G.W	8 / 9 Kgs	6 / 7 Kgs
Meas / QTY	46 x 29.5 x 35cm / 150 pcs	46 x 29.5 x 35cm / 150 pcs

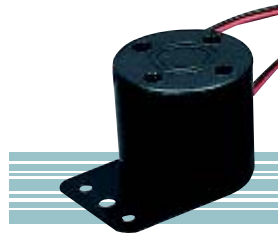

Color Black
ABS Housing Material
Steel Tab Mounted

DIMENSIONS

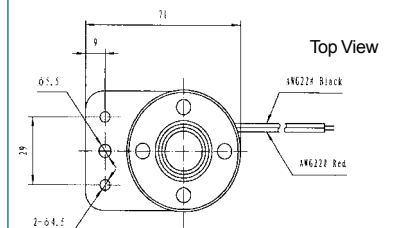
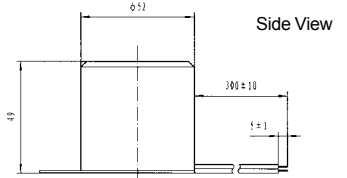

all dimensions are in mm

* Value applying at rated voltage

EPA-85S SERIES PIEZO ALARM

Model No EPA-85S1-12V

Rated Voltage	12 VDC
Operating Voltage	6~15 VDC
Max. Rated Current	100mA
Min. Sound Pressure Level	104 _i ±3dB /100cm
Resonant Frequency	3.3 _i ±0.5KHz
Tone Nature	Warble
Operating Temperature	-20 ~ +60 _i ±æ
Store Temperature	-30 ~ +70 _i ±æ
Weight	85g
N.W / G.W	12 / 13 Kgs
Meas / QTY	44.5 x 24 x 33cm / 140 pcs

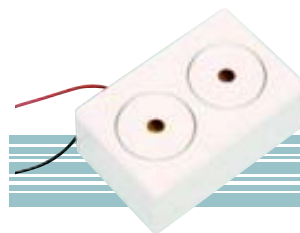

Color White
ABS Housing Material
Piezo Screamer

DIMENSIONS

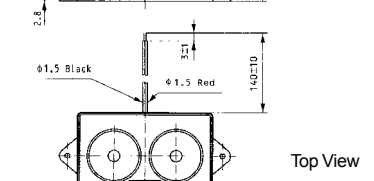
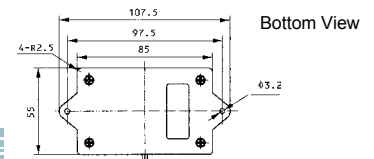

all dimensions are in mm

* Value applying at rated voltage

EPA-36S SERIES PIEZO ALARM

Model No	EPA-36S1-9V
Rated Voltage	9 VDC
Operating Voltage	8~48VDC
Max. Rated Current	3mA at 9VDC
Min. Sound Pressure Level	83 ; ±3dB at 9VDC/30cm
Resonant Frequency	200 ; ±15Hz
Tone Nature	AM Tone or Continuous
Operating Temperature	-20~+60 ; ±
Store Temperature	-30~+70 ; ±
Weight	28g



Color Black
ABS Housing Material

DIMENSIONS

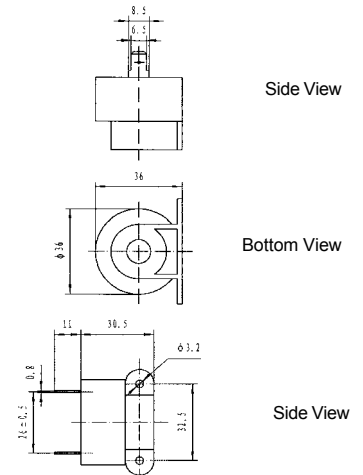

all dimensions are in mm

* Value applying at rated voltage

EPA-47S SERIES PIEZO ALARM

Model No	EPA-47S1-12V
Rated Voltage	12 VDC
Operating Voltage	6~15 VDC
Max. Rated Current	80mA at 12 VDC
Min. Sound Pressure Level	110dB at 12VDC/30cm
Resonant Frequency	1.5~3.5KHz
Tone Nature	Warble
Operating Temperature	-20 ~ +60 ; ±
Store Temperature	-30 ~ +70 ; ±
Weight	35g
N.W / G.W	17.5 / 18.5 Kgs
Meas / QTY	41.5 x 27.5 x 26cm / 500 pcs

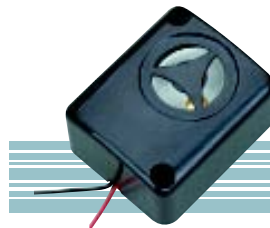

Color Black
ABS Housing Material

DIMENSIONS

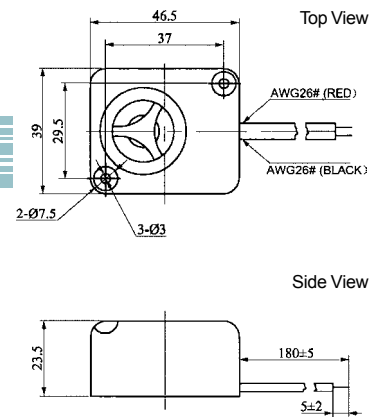

all dimensions are in mm

* Value applying at rated voltage

EPA-113S SERIES PIEZO ALARM

Model No	EPA-113S1-12V
Rated Voltage	12 VDC
Operating Voltage	6~14VDC
Max. Rated Current	65mA at 12VDC
Min. Sound Pressure Level	100 ; ±3dB at 12VDC/100cm
Resonant Frequency	2.8 ; ±0.5KHz
Tone Nature	Single Gang
Operating Temperature	-20~+60 ; ±
Store Temperature	-30~+70 ; ±
Weight	45g
Remark	Flush Mounted
N.W / G.W	2.5 / 3 Kgs
Meas / QTY	38 x 24 x 17cm / 50 pcs

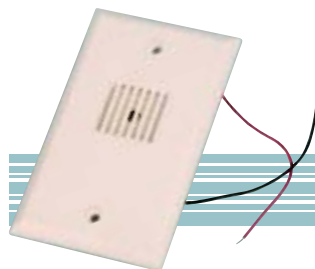

Color White
ABS Housing Material

DIMENSIONS

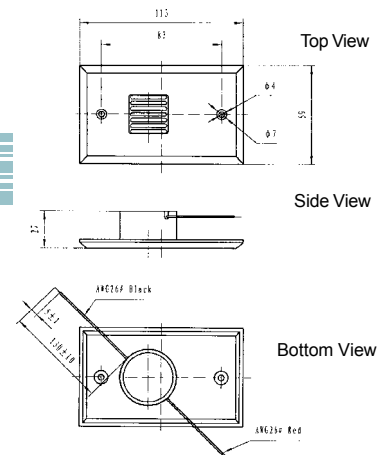

all dimensions are in mm

* Value applying at rated voltage

The information contained herein is believed to be correct, but no guarantee for accuracy/completeness DSW Electronics Ltd. reserves the right to make changes without notification.