

## Specification:

- \*3/8" diameter press to fit
- \*Longer leads available
- \*Switches or magnets available seperately
- \*Wide gap p to 1 1/2"+
- \*Build-in Resistors or Diodes on quest
- \*Colors: White, Brown, Grey
- \*Safety approvals:

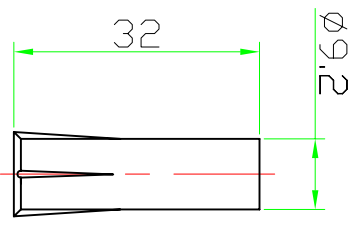

Magnet

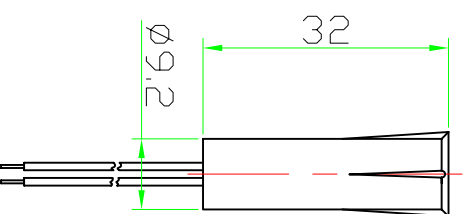

Switch

Part Number	Loop Type	Reed Form	Gap [Inch(mm)]	Maximum Initial Contact Resistance (ohm)	Maximum Contact Rating (w)	Maximum Switching Voltage (VDC/VAC)	Maximum Switching Current (A)
MCR-3101	Closed	N/O	1 (.25)	0.150	10	100	0.5
MCR-3101W	Closed	N/O	3/2 (.37)	0.150	10	100	0.5
MCR-3101A	Open	N/C	1 (.25)	0.150	3	30	0.2
MCR-3101C	Closed & Open	SPDT	1 (.25)	0.150	3	30	0.2

<b>DSW</b> NINGBO DSW AUDIO & SECURITY EQUIPMENT <a href="http://www.dswbrand.com">http://www.dswbrand.com</a>	
Magnetic Contacts	
MCR-3101	
No.	DESCRIPTION
<small>           CONFIDENTIALNESS            X            XXX #            90° FORMED ±2°            FIRST ANGLE PROJECTION         </small>	
APPROVED	DATE
CHECKED	DATE
UNIT	DWG. NO.
mm	E4.840.005
SCALE	SHEET
NOT TO SCALE	VER 1.0